



T1-PMXX-1XX Series

Porter Mini

06/29/2021

Porter Mini

Description:

- Contactless guest interactions
- Remote management
- Customer engagement and marketing
- API access for automatic updates
- Customer identification and interaction tracking



Porter mini shown with menu logo

Porter Mini makes sharing and interacting with guests effortless. The device caters to a variety of uses including serving menus, collecting feedback, facilitating reviews, and even sharing Wi-Fi networks. It may be set up in minutes using an Android or iOS device. When a guest scans the QR code, your content is delivered seamlessly onto their phone. The device may be configured to load custom branding on the guest's phone and collect guest email addresses. You may also direct the customer to view additional offers or information that may be helpful during their visit.

Remote management features allow you to update your messaging, content, and other information instantly from any location. You may also schedule content to appear at a certain time, or at regular times during the week. Porter Hospitality models are managed in groups, called locations. Each location may be customized and controls the guest experience for every Porter associated with it. In addition to managing locations on your mobile device, you may also configure automatic management using the Porter API. This enables a variety of new use cases, such as greeting your guest by name or automatically updating the information provided by the Porter.

By providing contactless sharing, Porter Mini provides an excellent alternative to distributing information on physical media such as paper menus or brochures, and is itself simple to clean and sterilize.

| Part Number | Description |
|-------------|--|
| T1-PMN1-100 | Maple Porter Mini without a front icon marking |
| T1-PMN1-101 | Maple Porter Mini with a Wi-Fi icon marking |
| T1-PMN1-102 | Maple Porter Mini with an info icon marking |
| T1-PMN1-103 | Maple Porter Mini with a menu icon marking |
| T1-PMN1-104 | Maple Porter Mini with a martini icon marking |
| T1-PMN1-105 | Maple Porter Mini with a rating icon marking |



Available icon markings



T1-PMXX-1XX Series

Porter Mini

06/29/2021

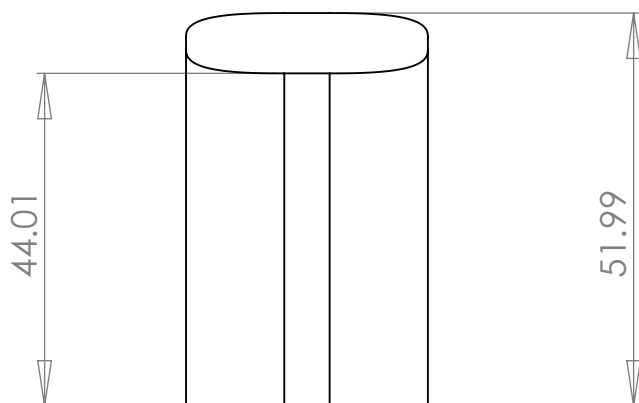
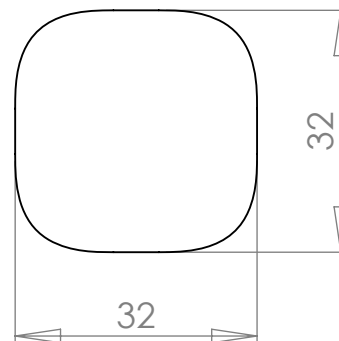
Dimensions:**Front view showing height****Top view**

UNLESS OTHERWISE SPECIFIED:

DIMENSIONS ARE IN MM

TOLERANCES:

X.X ±0.4

X.XX ±0.20

X.XXX ±0.100

SCALE: 1:1

| Item | Specification |
|------------------------------------|---|
| Weight (boxed) | 42g |
| Weight (unboxed) | 39g |
| Boxed dimensions | 68 x 39 x 37mm |
| Power requirements | No batteries or external source required |
| Operating temperature range | -20°C to + 70°C |
| Setup instructions | https://portersetup.com/scan |